



Enabling Your Ideas

Universal Spindle Arm

Universal Spindle Arm

PN: 30287

The Universal Spindle Arm is designed to mount equipment to the spindle nose of the PCNC 1100 mill. It can be used for:

- Mounting a high speed companion spindle such as a woodworking router or die grinder.
- Providing torque arm support for a Tapmatic or Tapmatic style tapping head.
- Coolant nozzle support.
- Work light support.
- Vacuum pickup for collection of precious metals or abrasive materials.
- Anything else which needs a sturdy support and positive reference position relative to the machine spindle.



30287 - Spindle Arm & Screws

The arm is made of cast iron and machined flat on 4 sides. Each of the four sides is drilled and tapped for 4 M5x0.8 screws. The design provides adequate wall thickness to drill out these holes if larger or imperial thread mount is preferred. The spindle nose of the PCNC 1100 is $3\text{-}\frac{7}{16}$ inches (87.3 mm), the same as that of the Bridgeport knee mill. This allows the arm to mount on Bridgeport mills as well as a wide variety of similar small milling machines.

Each spindle arm comes with 10 screws:

- 4 each M5 x 16 mm, for general purpose mounting
- 4 each M5 x 25 mm, for general purpose mounting
- 2 each M8 x 30 mm, clamp closure



Universal Spindle Arm

Enabling Your Ideas

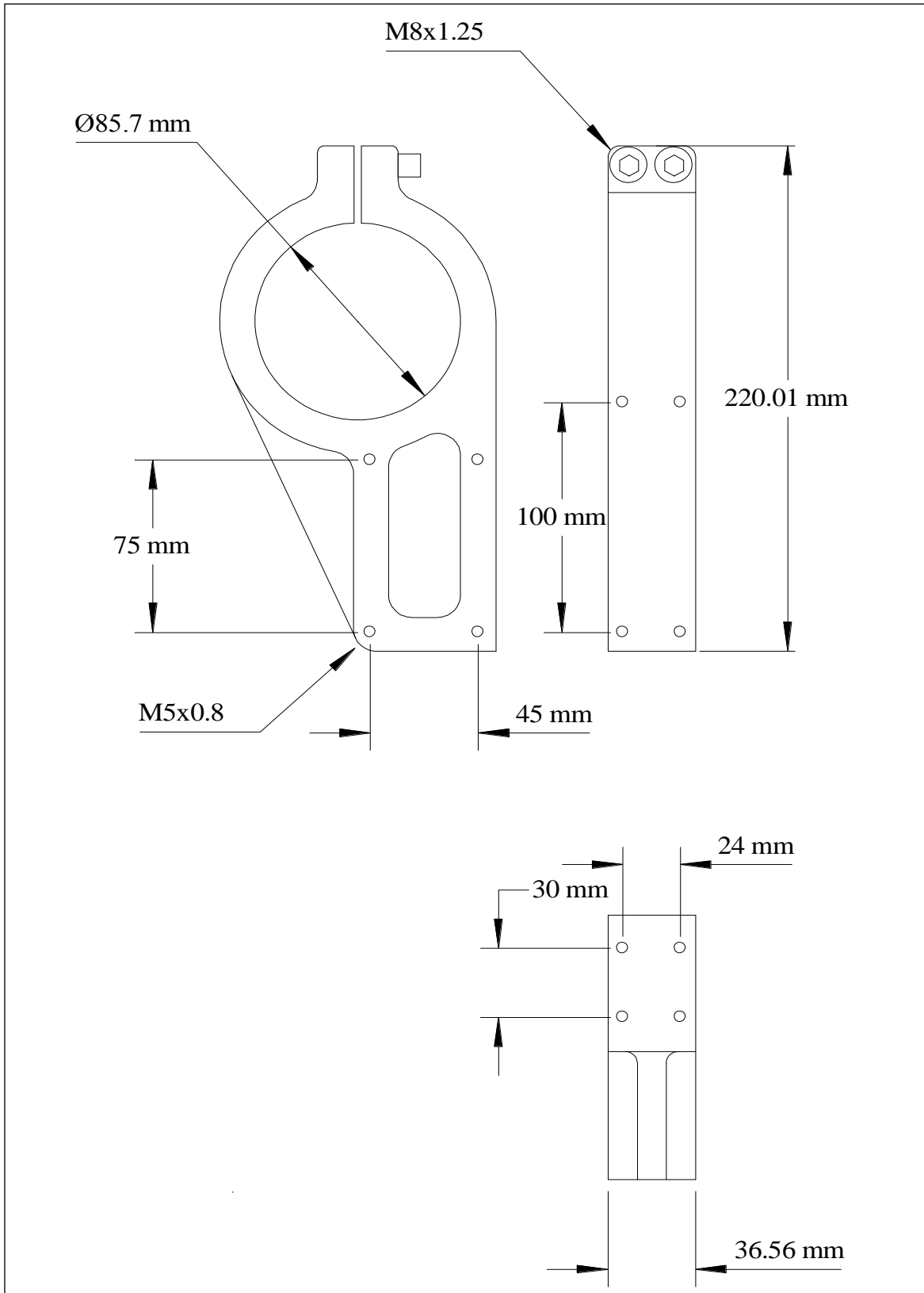

WWW.TORMACH.COM - Email: info@tormach.com

204 Moravian Valley Rd, Suite N Waunakee, WI 53597 phone 608.849.8381 fax 209.885.4534

page 2 of 2 - filename: DS30287_Spindle_Arm.pdf - date: 7/26/2006

Copyright Tormach LLC 2006 - Specifications are subject to change without notice